

COMMERCIAL DOCUMENTATION



FIXING INSERTS | BSX **FIXING INSERTS WITH WAVE END**



FIXING INSERTS WITH WAVE END – BSX

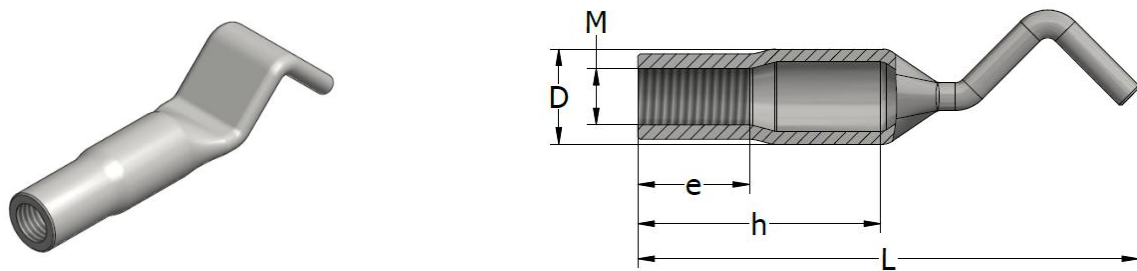

Fixing inserts BSX are manufactured from steel precision tube S235JR NBK hot dip galvanized (TV), electrolytic galvanised EV or from stainless steel tube 1.4404 (SS4). **Do not use these inserts for lifting.**

BSX-TV	Product no.	Thread	Overall Length L	D	e	h	Admissible load
		M	[mm]	[mm]	[mm]	[mm]	[kN]
BSX M10x55-TV	49102	10	55	13	10	20	4.0
BSX M10x75-TV	49104	10	75	13	10	20	5.0
BSX M12x95-TV	49106	12	95	17.2	21	45	6.0
BSX M12x135-TV	45204	12	135	17.2	21	45	7.0
BSX M16x100-TV	49081	16	100	22	30	45	10.0
BSX M16x125-TV	49083	16	125	22	30	45	11.0
BSX M16x135-TV	48894	16	135	22	21	45	12.0
BSX M20x100-TV	49085	20	100	27	30	45	16.0
BSX M20x125-TV	49087	20	125	27	30	45	16.0
BSX M24x120-TV	49108	24	120	32	33	55	16.0
BSX M30x145-TV	49114	30	145	38	36	65	16.0

BSX-EV	Product no.	Thread	Overall Length L	D	e	h	Admissible load
		M	[mm]	[mm]	[mm]	[mm]	[kN]
BSX M12x95-EV	49410	12	95	17.2	21	45	6.0
BSX M12x135-EV	49411	12	135	17.2	21	45	7.0
BSX M16x135-EV	48893	16	135	22	21	45	12.0

BSX-SS4 (W 1.4301)	Product no.	Thread	Overall Length L	D	e	h	Admissible load
		M	[mm]	[mm]	[mm]	[mm]	[kN]
BSX M10x55-SS4	49103	10	55	13	10	20	4.0
BSX M10x75-SS4	49105	10	75	13	10	20	5.0
BSX M12x95-SS4	49107	12	95	17.2	21	45	6.0
BSX M12x135-SS4	45285	12	135	17.2	21	45	7.0
BSX M16x100-SS4	49082	16	100	22	30	45	10.0
BSX M16x125-SS4	49084	16	125	22	30	45	11.0
BSX M16x135-SS4	48892	16	135	22	21	45	12.0
BSX M20x100-SS4	49086	20	100	27	30	45	16.0
BSX M20x125-SS4	49088	20	125	27	30	45	16.0
BSX M24x120-SS4	49109	24	120	32	33	55	16.0
BSX M30x145-SS4	49115	30	145	38	36	65	16.0

CONTACT

TERWA is the global supplier for precast and construction solutions with multiple offices around the world. With all our staff, partners and agents, we are happy to provide all construction and precast companies who work in the building industry with full service and 100% support.

TERWA CONSTRUCTION GROUP
Terwa Construction Netherlands (HQ)

Global Sales & Distribution
 Kamerlingh Onneslaan 1-3
 3401 MZ IJsselstein
 The Netherlands
T +31-(0)30 699 13 29
F +31-(0)30 220 10 77
E info@terwa.com

Terwa Construction Central East Europe

Sales & Distribution
 Strada Sânzieni
 507075 Ghimbav
 Romania
T +40 372 611 576
E info@terwa.com

Terwa Construction Poland

Sales & Distribution
 Ul. Cicha 5 lok. 4
 00-353 Warszawa
 Poland
E info@terwa.com

Terwa Construction India & Middle East

Sales & Distribution
 India
T +91 89 687 000 41
E info@terwa.com

Terwa Construction China

Sales & distribution
 5F 504, No. 101 Chuanchang road
 PRC, 200032, Shanghai
 China
E info@terwa.com

ALL SPECIFICATIONS CAN BE CHANGED WITHOUT PREVIOUS NOTICE.

DISCLAIMER

Terwa B.V. is not liable for deviations due to wear of the products it has delivered. Neither is Terwa B.V. liable for damage due to inaccurate and/or improper handling and use of the products it has delivered and/or use of same for purposes other than those intended.

Terwa B.V.'s responsibility is furthermore limited in accordance with article 13 of the "Metaalunie" conditions, which are applicable for all Terwa B.V. deliveries. The user is responsible for ensuring compliance with all applicable copyright laws. Without limiting the rights under copyright, no part of this documentation may be reproduced, stored in or introduced into a retrieval system, or transmitted in any form or by any means (electronic, mechanical, photocopying, recording, or otherwise), or for any purpose, without the express written permission of Terwa B.V.